

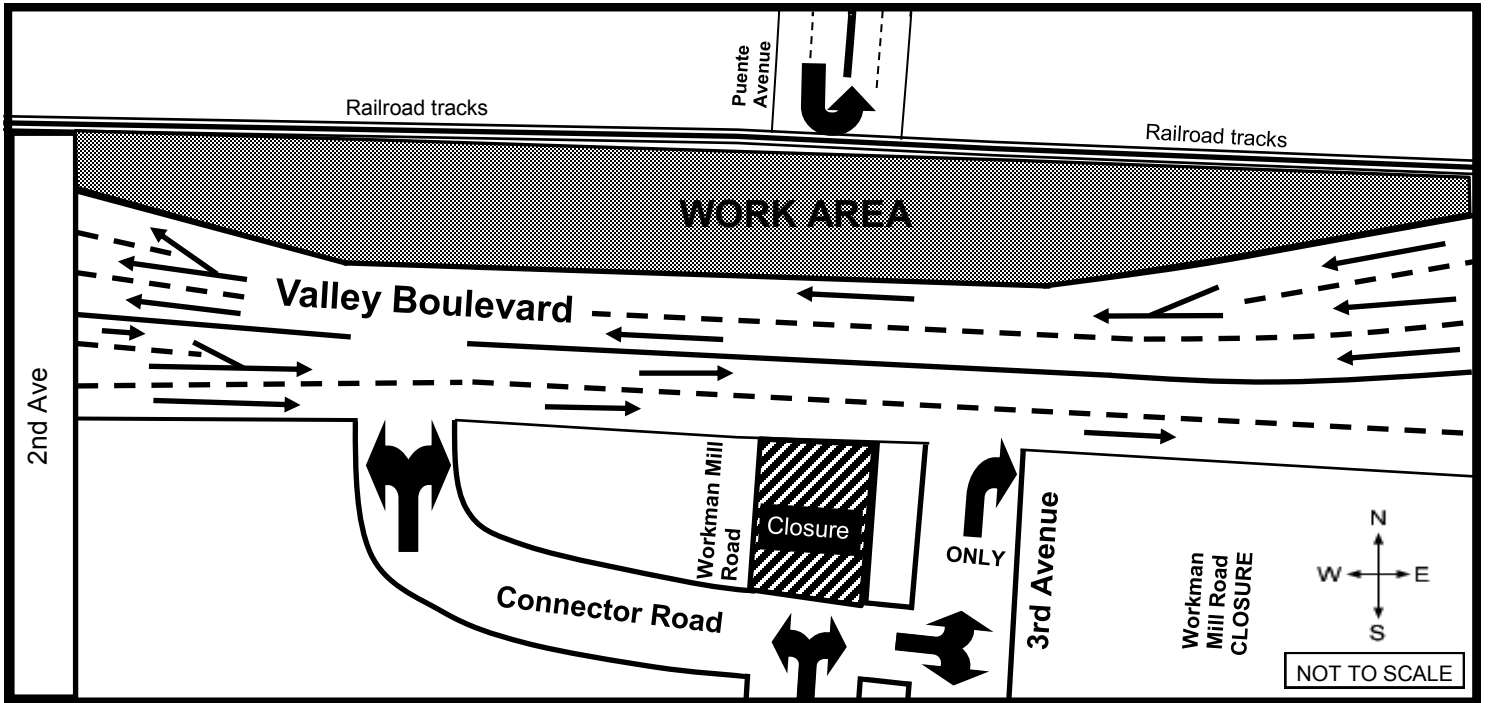

****CONSTRUCTION ALERT ****

VALLEY BLVD. TRAFFIC SHIFTED TO SOUTH FOR NEXT STAGE OF BRIDGE CONSTRUCTION



WHAT

The Alameda Corridor-East Construction Authority (ACE) contractor will conduct overnight traffic lane shifts to the south on Valley Boulevard and open 3rd Avenue for access to eastbound Valley Boulevard as part of the Puente Avenue Grade Separation Project.

WHAT TO EXPECT

The contractor will remove and construct pavement along the northern portion of the Valley Boulevard bridge in the area depicted in the map above. **Work will require the shifting of all Valley Boulevard traffic lanes to the south.** To minimize traffic impacts, the work is being scheduled in the evening. Motorists and pedestrians should exercise caution while in the vicinity of the work area. Noise, dust and vibration will be monitored for compliance with applicable limits.

WHEN

Work will begin at **7 p.m. on Thursday, March 2, 2017** and is expected to be completed the following morning by **6 a.m. on Friday, March 3, 2017.**

Para información o preguntas, por favor llame al teléfono directo o visite el sitio web en:

如有疑問或需要索取工程最新資料，請致電輔助熱線或參閱工程網頁

**For the most up-to-date information or questions, please call or visit:
(888) ACE-1426 or www.theaceproject.org**

Thank you for your patience and cooperation...At ACE, it's Safety First!

*Note: Construction is a dynamic process and information is subject to change without notice.
Work activity is subject to weather conditions.*