

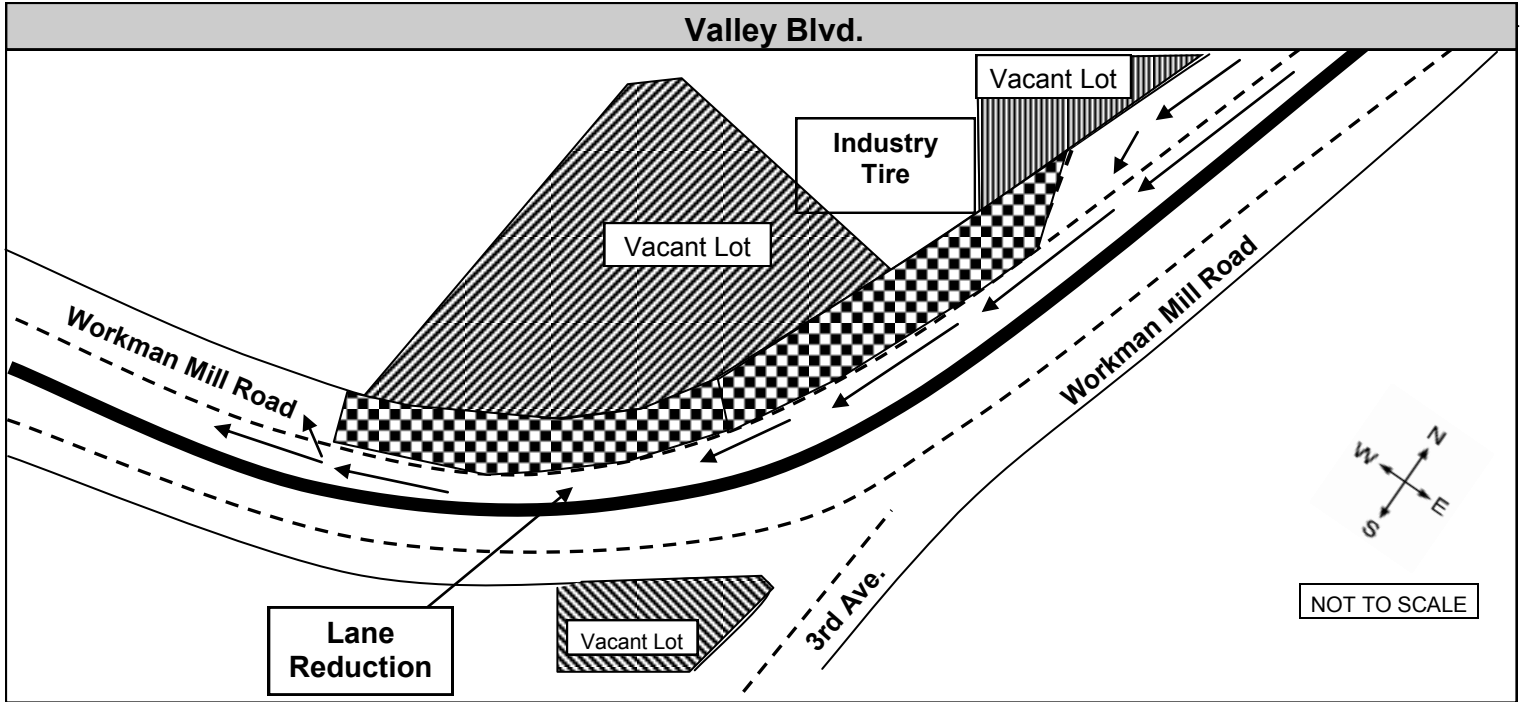

****CONSTRUCTION ALERT****

**LANE REDUCTION ON SOUTHBOUND WORKMAN MILL RD.
SOUTH OF VALLEY BLVD.**



WHAT

As part of the Puente Avenue Grade Separation Project, the Alameda Corridor-East Construction Authority (ACE) contractor will close one lane on a section of the west side of Workman Mill Road just south of Valley Blvd. for approximately 36 months. There may be intermittent northbound lane closures.

WHAT TO EXPECT

One traffic lane, roadway shoulder and sidewalk on southbound Workman Mill Road will be closed for the duration of the project. Access to driveways and local businesses will be maintained. Construction activities will require the use of trucks, tractors and other construction equipment. Motorists and pedestrians are urged to exercise caution while in the vicinity of the work area. Pedestrian access is available on the east side of Workman Mill Road. Noise, dust and vibration will be monitored for compliance within applicable limits.

WHEN

Construction activities on Workman Mill Road began on **Monday, March 2, 2015** and are expected to continue for approximately 36 months. Most work will occur weekdays between 7 a.m. and 5 p.m.

Para información o preguntas, por favor llame al teléfono directo o visite el sitio web en:

如有疑問或需要索取工程最新資料，請致電輔助熱線或參閱工程網頁

**For the most up-to-date information or questions, please call or visit:
(888) ACE-1426 or www.theaceproject.org**

Thank you for your patience and cooperation...At ACE, it's Safety First!

*Note: Construction is a dynamic process and information is subject to change without notice.
Work activity is subject to weather conditions.*