



# Alameda Corridor-East Construction Authority

4900 Rivergrade Road, Ste. 120 Irwindale, CA 91706 (626) 962-9292 fax (626) 472-0094 www.theaceproject.org

## **\*\*CONSTRUCTION ALERT\*\***

### **WORKMAN MILL RD. BETWEEN VALLEY BLVD. AND 3RD AVE. TO CLOSE BEGINNING DECEMBER 21; NEW CONNECTOR ROAD TO OPEN**

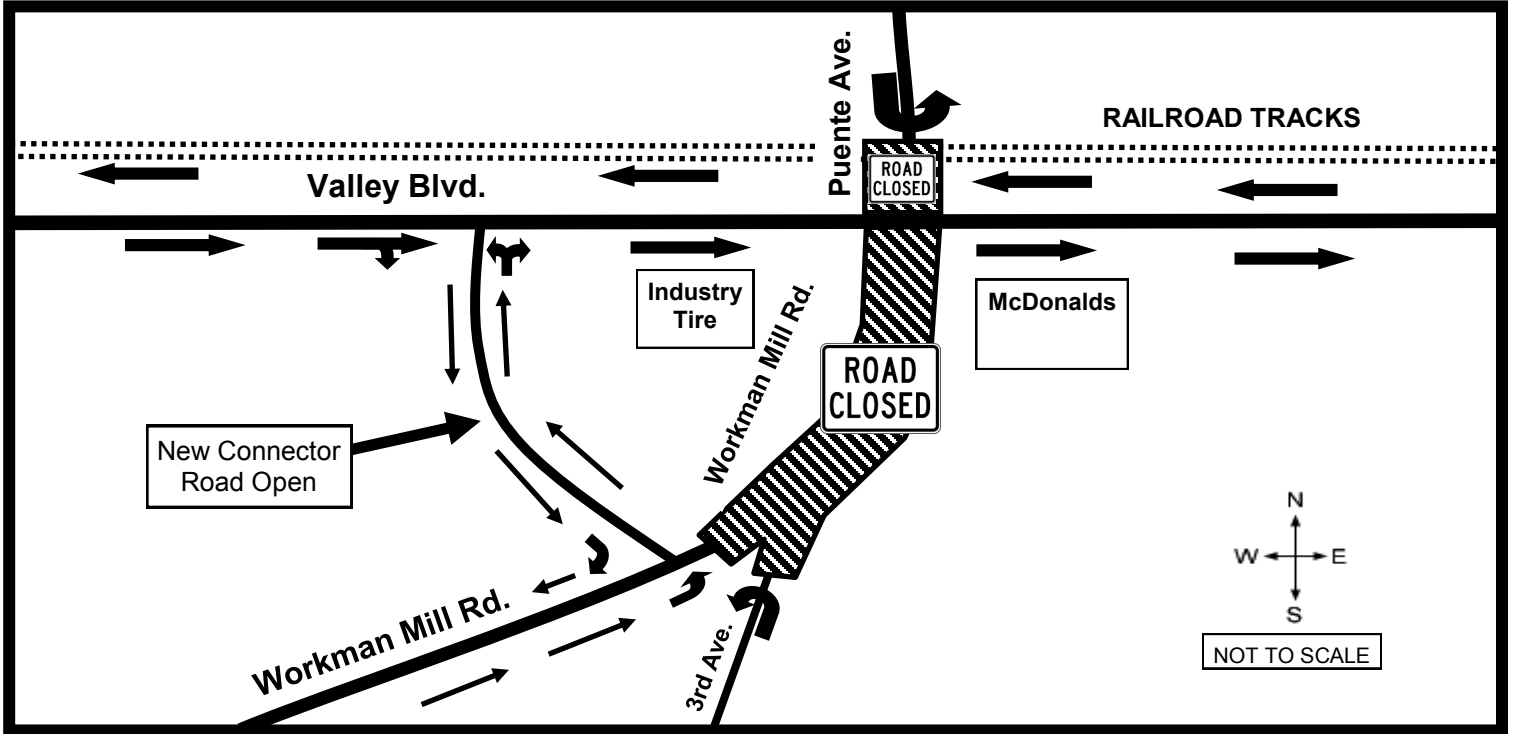

#### **WHAT/WHERE**

Workman Mill Road will be closed to vehicle traffic and pedestrians between Valley Boulevard and 3rd Avenue for approximately 30 months. In addition, 3rd Avenue will be closed to through traffic at Workman Mill Road. The closures are required to lower Workman Mill Road/Puente Avenue for construction of the Puente Avenue grade separation project. To provide a connection between Workman Mill Road and Valley Boulevard, the newly constructed connector road will open to traffic (see map above).

#### **WHAT TO EXPECT**

Northbound and southbound traffic lanes on Workman Mill Road between Valley Boulevard and 3rd Avenue will be closed for the duration of the project. U-turns and left turns from westbound Valley Boulevard to the connector road will not be permitted. Access to local businesses will be maintained. Valley Boulevard will remain open to through traffic during the project. Motorists and pedestrians are urged to exercise caution while in the vicinity of the work area. Noise, dust and vibration will be monitored for compliance with applicable limits.

#### **WHEN**

The section of Workman Mill Road will close some time between 7 p.m. the evening of **Monday, December 21, 2015** and **6 a.m.** the following morning on **Tuesday, December 22, 2015**. The connector road will simultaneously open to traffic upon the closure of Workman Mill Road.

*Para información o preguntas, por favor llame al teléfono directo o visite el sitio web en:*

*如有疑問或需要索取工程最新資料，請致電輔助熱線或參閱工程網頁*

**For the most up-to-date information or questions, please call or visit:  
(888) ACE-1426 or [www.theaceproject.org](http://www.theaceproject.org)**

*Thank you for your patience and cooperation...At ACE, it's Safety First!*

*Note: Construction is a dynamic process and information is subject to change without notice.  
Work activity is subject to weather conditions.*