

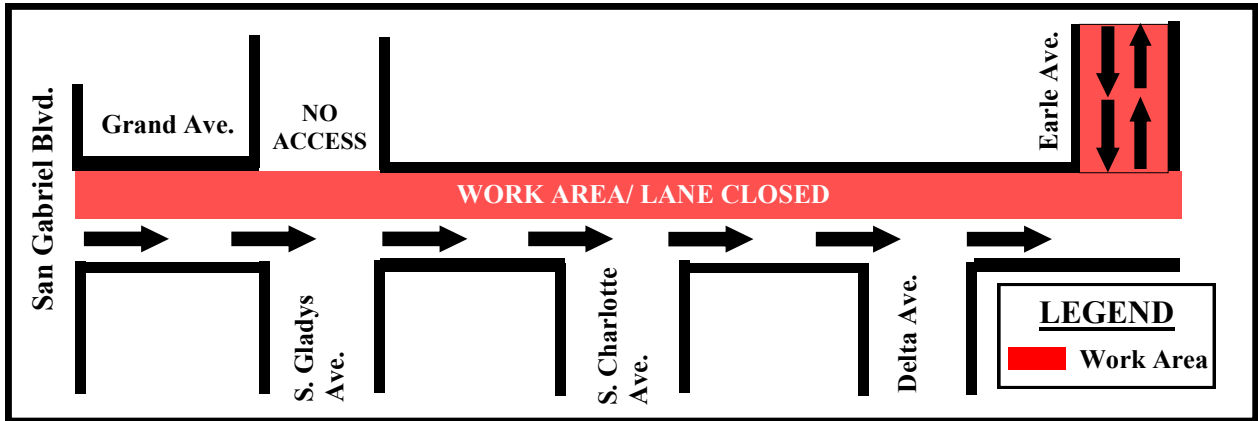

CONSTRUCTION ALERT: 5/22/17-6/6/17 TEMPORARY TRAFFIC LANE IMPACTS ON GRAND AVE. AND EARLE AVE. FOR PAVEMENT REHABILITATION

PHASE 1



PHASE 2

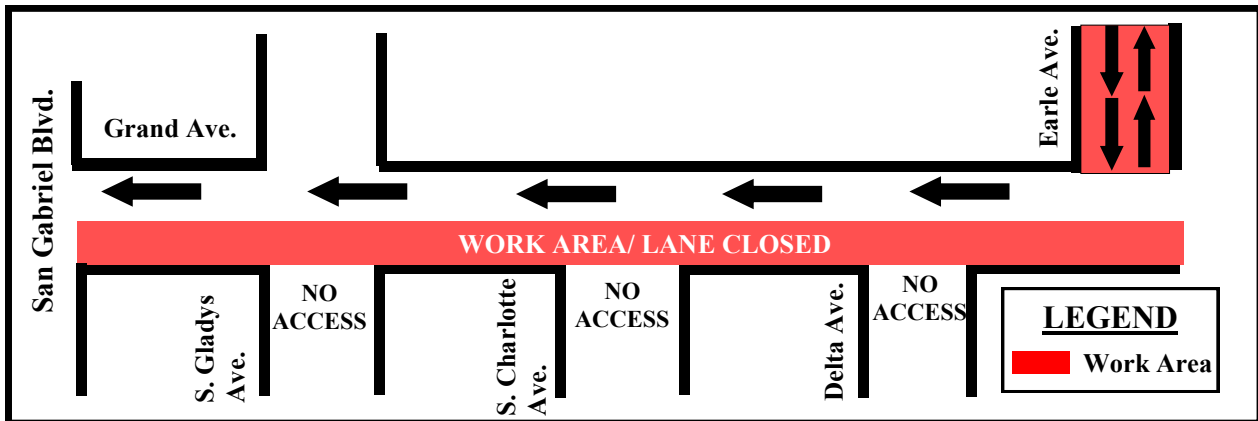

Beginning **Monday, May 22, 2017** to **Tuesday, June 6, 2017**, contractor will remove and replace the pavement along Earle Avenue and Grand Avenue (from San Gabriel Boulevard to Earle Avenue). Grand Avenue and Earle Avenue will remain open and at least one lane of traffic will be maintained at all times. Driveway access may be impacted during work hours. No street parking will be permitted on Grand Avenue during duration of project. Please follow parking signs for Earle Avenue. Pedestrian access will be available. Most work will occur weekdays between 7:00 a.m. and 7:00 p.m. Motorists and pedestrians are encouraged to follow detour routes, obey posted signs and exercise caution. Noise, dust and vibration may be noticeable, and will be monitored for compliance with applicable limits.

Para información o preguntas, por favor llame al teléfono directo o visite el sitio web en:

如有疑問或需要索取工程最新資料，請致電輔助熱線或參閱工程網頁

**For the most up-to-date information or questions, please call or visit:
(888) ACE-1426 (Available 24/7) or www.theaceproject.org**

In case of an emergency, please contact 9-1-1

Thank you for your patience and cooperation...At ACE, it's Safety First!

Note: Construction is a dynamic process and information is subject to change without notice.
Work activity is subject to weather conditions.